

Compulsory Purchase Cabinet Report

Appendix 3 – Maps of property Location

**Map 1 referred to in the LONDON BOROUGH OF HARINGEY
(Ground floor flat 15a Terront Road London N15 3AA) COMPULSORY PURCHASE ORDER 2009**

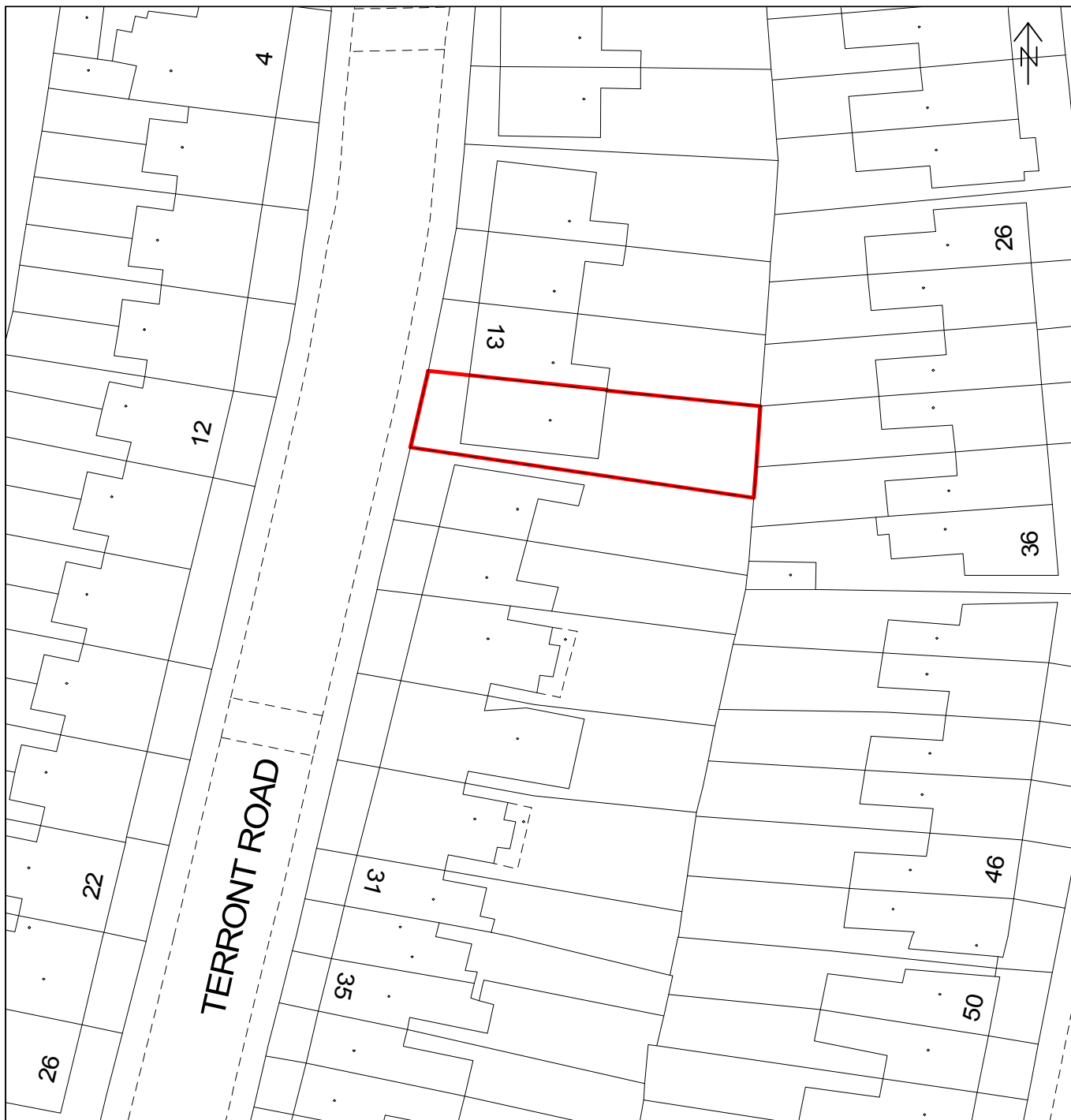

This product includes mapping data licenced from Ordnance Survey with the permission of the Controller of Her Majesty's Stationery Office Crown Copyright 2009 LBH. All rights reserved. Licence no. 100019199

Haringey Council
CORPORATE PROPERTY SERVICES

Anthony Roberts Share of freehold
(MX402315 shared freehold title)

Site Area (square metres) : n/a

Overlay : *Property Terrier*

Plan produced by Janice Dabinett on 01/05/2009

Scale 1:500

Drawing No. BVES A4 2579

**Map 2 referred to in the LONDON BOROUGH OF HARINGEY
(Ground floor flat 15a Terront Road London N15 3AA) COMPULSORY PURCHASE ORDER 2009**



This product includes mapping data licenced from Ordnance Survey with the permission of the Controller of Her Majesty's Stationery Office Crown Copyright 2009 LBH. All rights reserved. Licence no. 100019199

**Haringey Council
CORPORATE PROPERTY SERVICES**

The CPO is of the leasehold interest comprised in title NGL258032 and shown edged red.
As to the area shaded blue the CPO includes only the ground floor

Site Area (square metres) : n/a

Overlay : Property Terrier

Plan produced by Janice Dabinett on 01/05/2009

Scale 1:500

Drawing No. BVES A4 2579a

**Map referred to in the LONDON BOROUGH OF HARINGEY
(26 Gedeney Road London N17 7DY) COMPULSORY PURCHASE ORDER 2009**

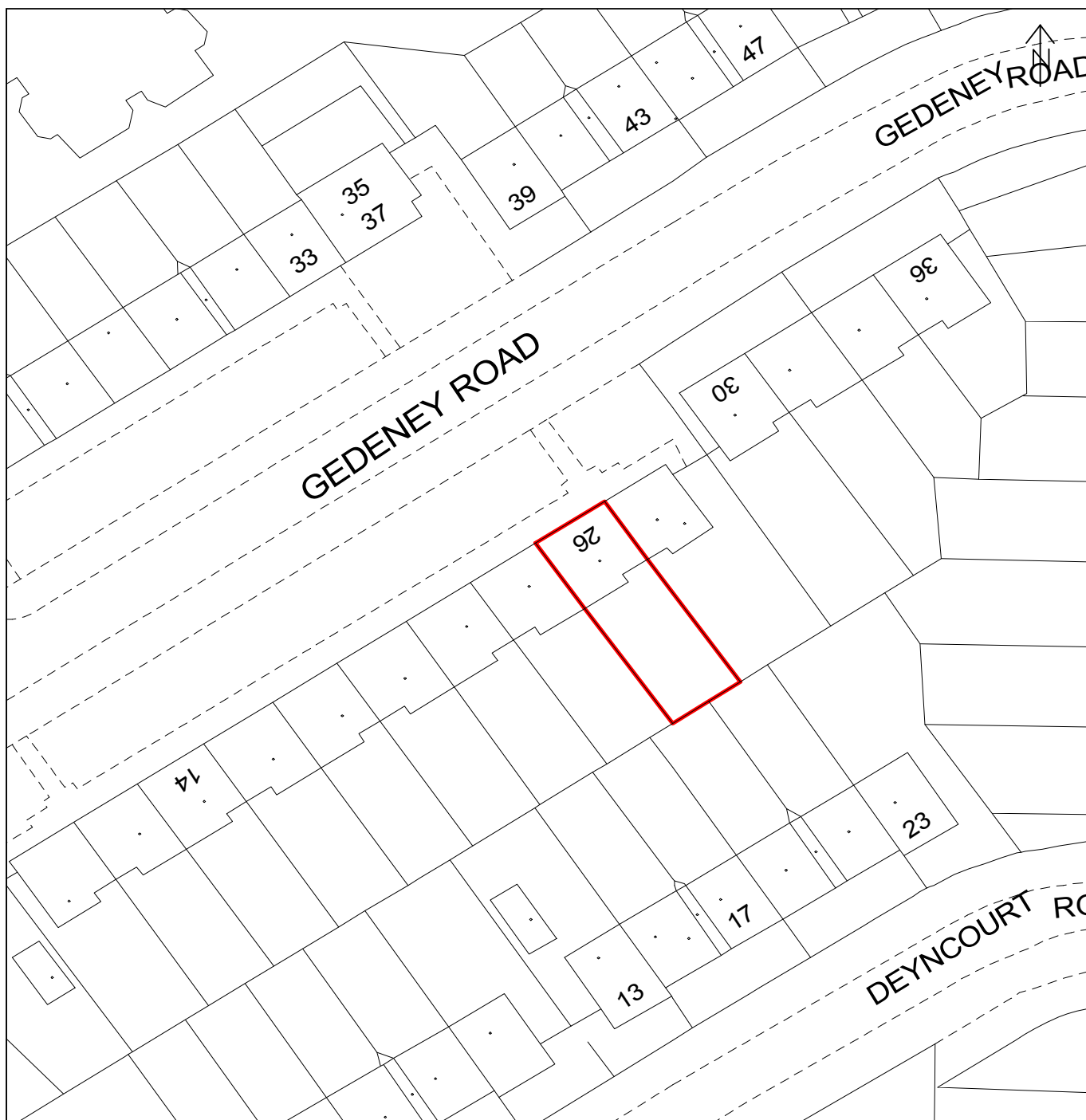

This product includes mapping data licenced from Ordnance Survey with the permission of the Controller of Her Majesty's Stationery Office Crown Copyright 2009 LBH. All rights reserved. Licence no. 100019199

**Haringey Council
CORPORATE PROPERTY SERVICES**

NGL329695 freehold

Site Area (square metres) : 139 sq m

Scale 1:500

Overlay : Property Terrier

Plan produced by Janice Dabinett on 20/03/2009

Drawing No. BVES A4 2578

**Map referred to in the LONDON BOROUGH OF HARINGEY
(39 Broad Lane London N15 4DJ) COMPULSORY PURCHASE ORDER 2009**

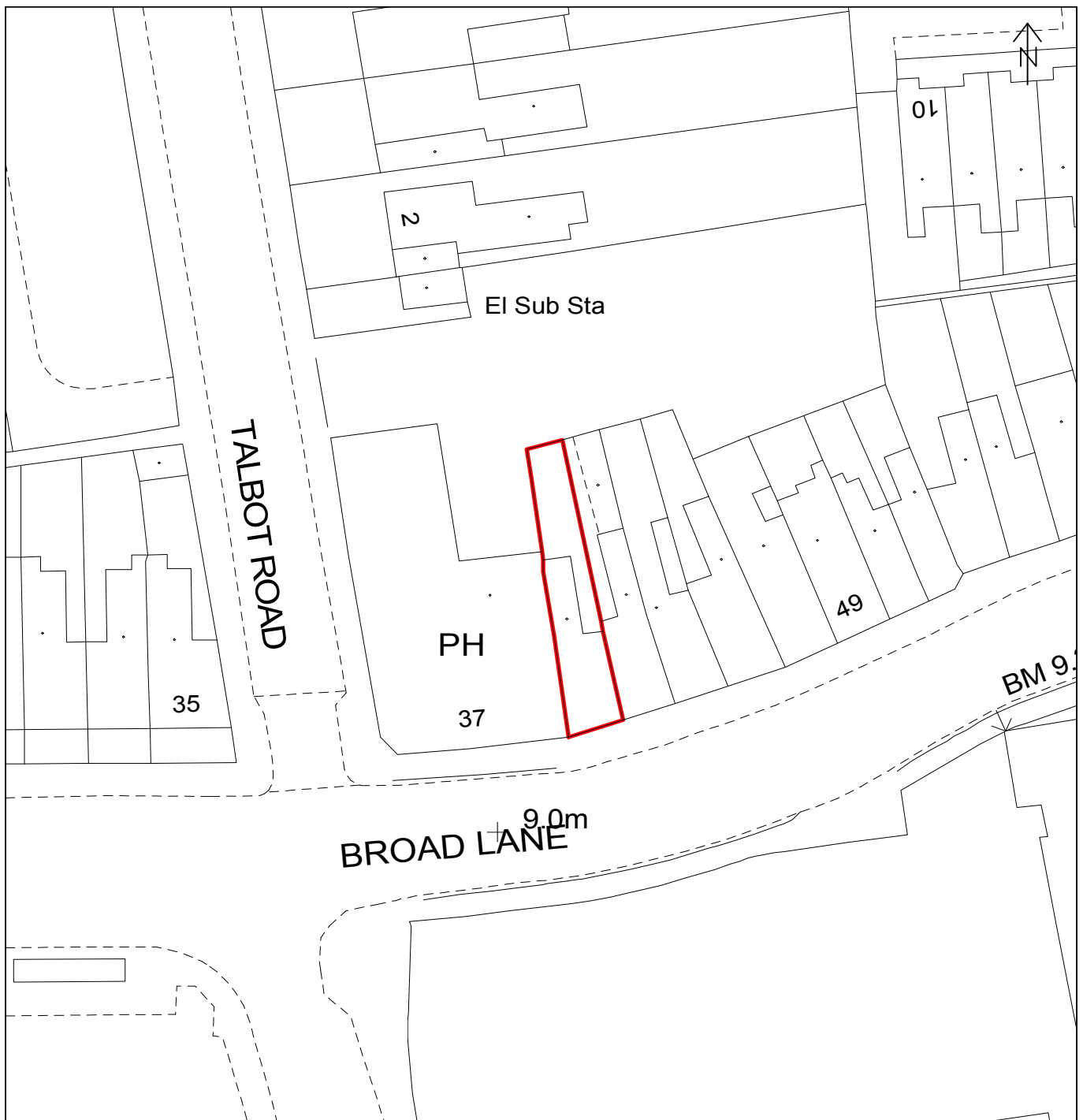

This product includes mapping data licenced from Ordnance Survey with the permission of the Controller of Her Majesty's Stationery Office Crown Copyright 2009 LBH. All rights reserved. Licence no. 100019199

**Haringey Council
CORPORATE PROPERTY SERVICES**

MX441481 freehold

Site Area (square metres) : 104 sq m

Scale 1:500

Overlay : *Property Terrier*

Plan produced by Janice Dabinett on 20/03/2009

Drawing No. BVES A4 2577

**Map referred to in the LONDON BOROUGH OF HARINGEY
(160 Seaford Road London N15 5DS) COMPULSORY PURCHASE ORDER 2009**

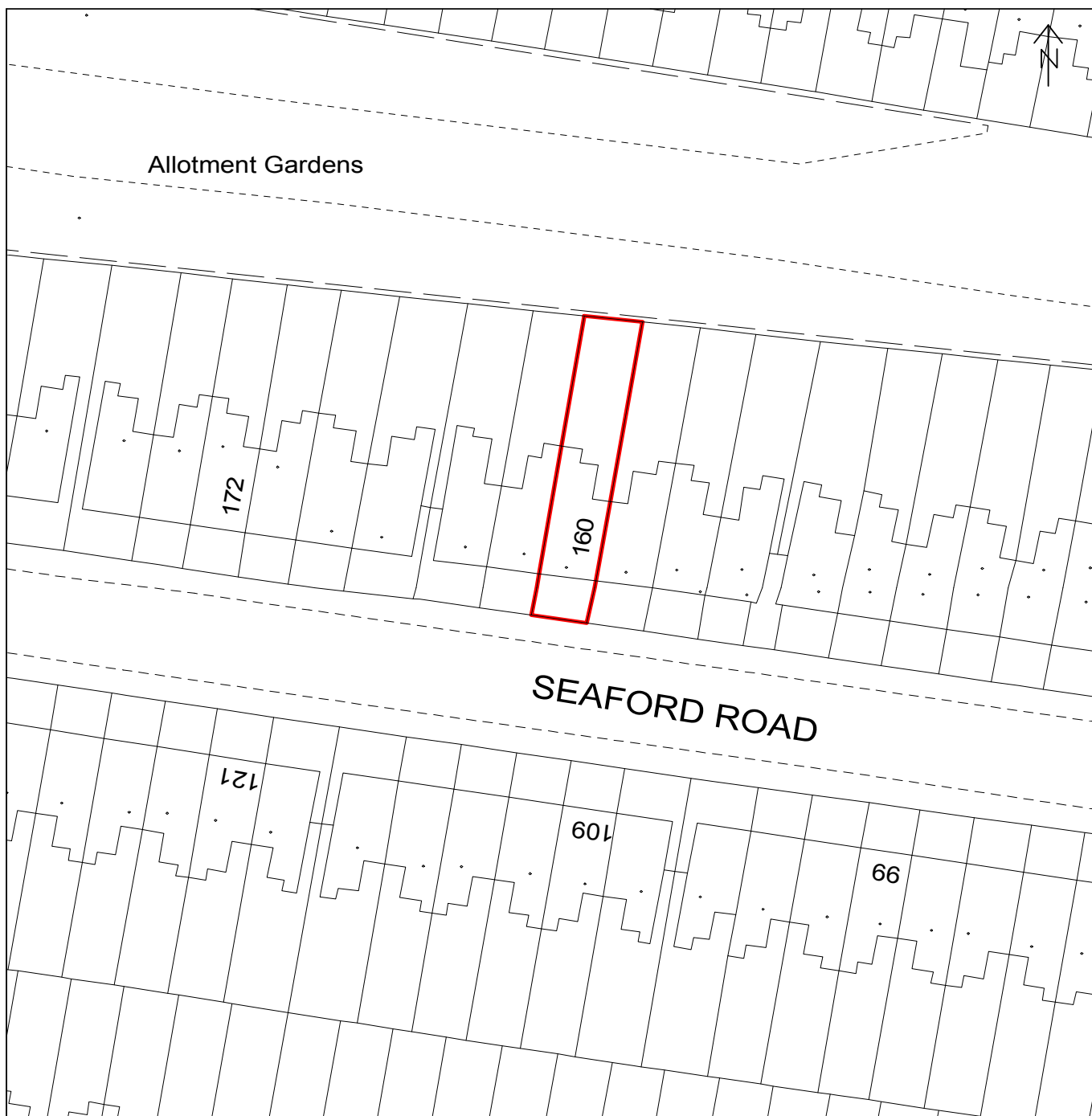

This product includes mapping data licenced from Ordnance Survey with the permission of the Controller of Her Majesty's Stationery Office Crown Copyright 2009 LBH. All rights reserved. Licence no. 100019199

**Haringey Council
CORPORATE PROPERTY SERVICES**

MX50775 freehold

Site Area (square metres) : 135 sq m

Scale 1:500

Overlay : Property Terrier

Plan produced by Janice Dabinett on 20/03/2009

Drawing No. BVES A4 2584

**Map referred to in the LONDON BOROUGH OF HARINGEY
(95 Birkbeck Road London N17 8NH) COMPULSORY PURCHASE ORDER 2009**

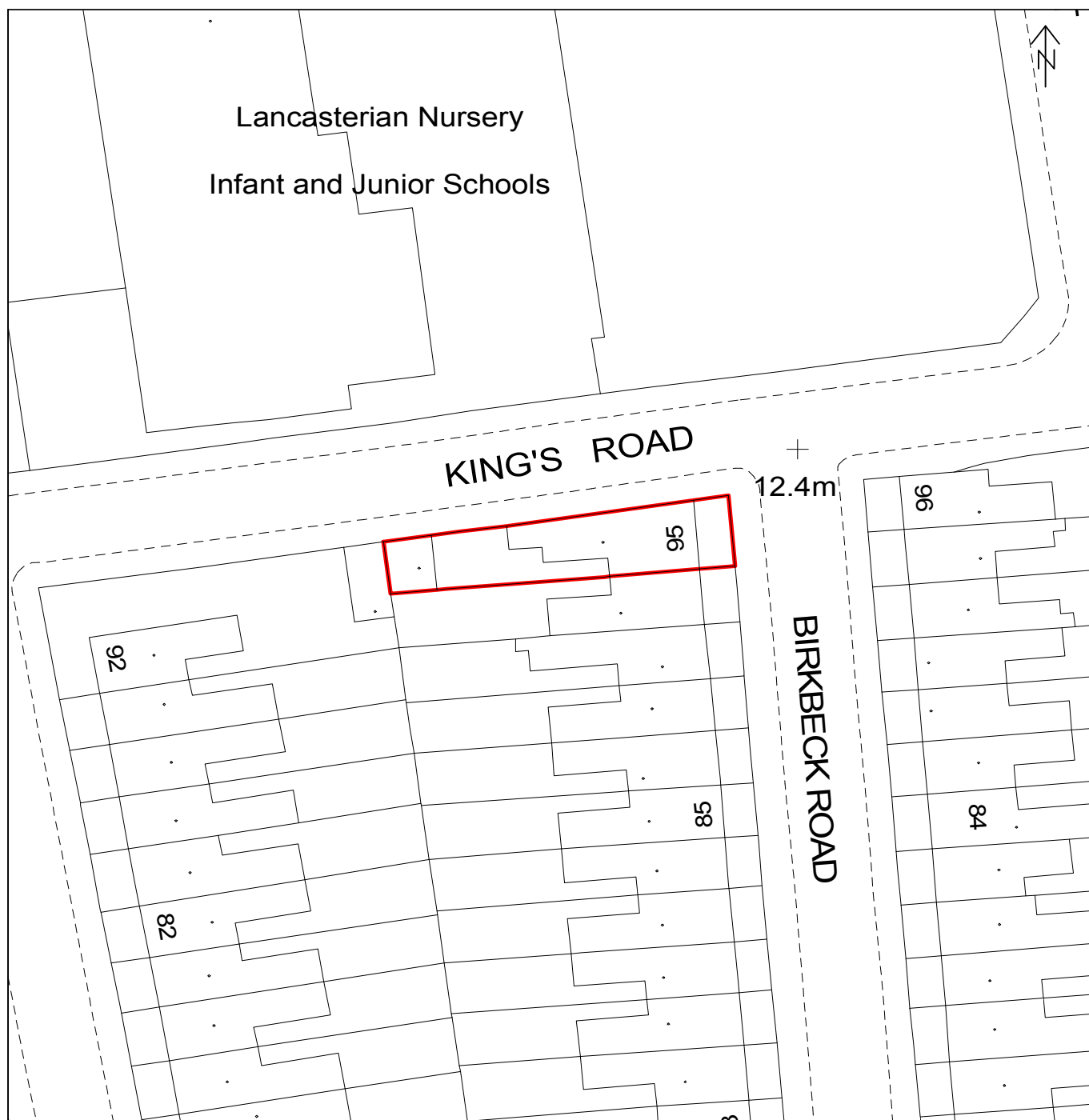

This product includes mapping data licenced from Ordnance Survey with the permission of the Controller of Her Majesty's Stationery Office Crown Copyright 2009 LBH. All rights reserved. Licence no. 100019199

**Haringey Council
CORPORATE PROPERTY SERVICES**

MX217324 freehold

Site Area (square metres) : 164 sq m

Overlay : *Property Terrier*

Plan produced by Janice Dabinett on 30/04/2009

Scale 1:500

Drawing No. BVES A4 2594

**Map referred to in the LONDON BOROUGH OF HARINGEY
(1 Strode Road London N17 6TZ) COMPULSORY PURCHASE ORDER 2009**

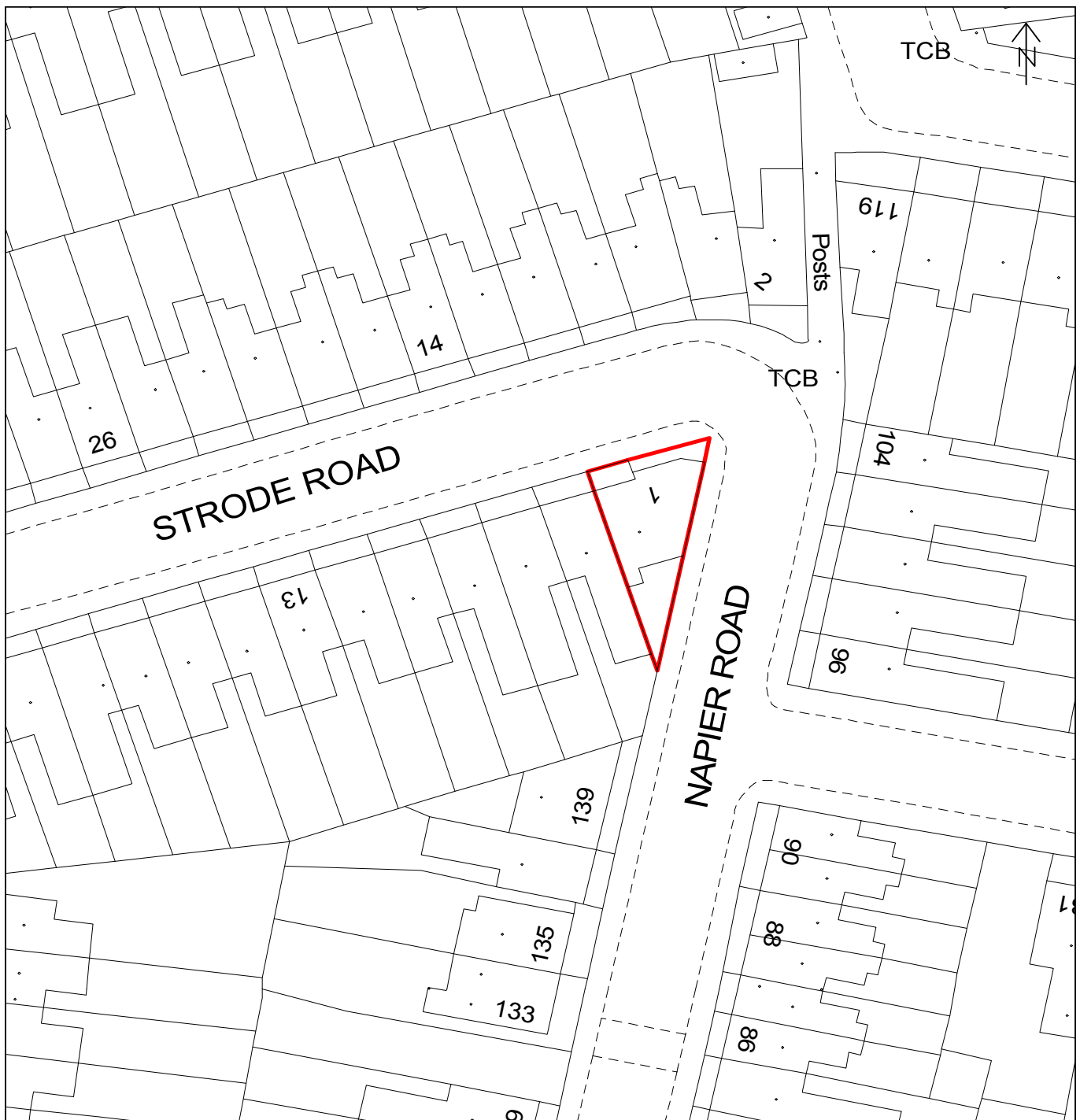

This product includes mapping data licenced from Ordnance Survey with the permission of the Controller of Her Majesty's Stationery Office Crown Copyright 2009 LBH. All rights reserved. Licence no. 100019199

**Haringey Council
CORPORATE PROPERTY SERVICES**

MX93561 freehold

Site Area (square metres) : 105 sq m

Scale 1:500

Overlay : *Property Terrier*

Plan produced by Janice Dabinett on 20/03/2009

Drawing No. BVES A4 2576

**Map referred to in the LONDON BOROUGH OF HARINGEY
(Ground floor maisonette 174 Sirdar Road London N22 6QX) COMPULSORY PURCHASE ORDER 2009**

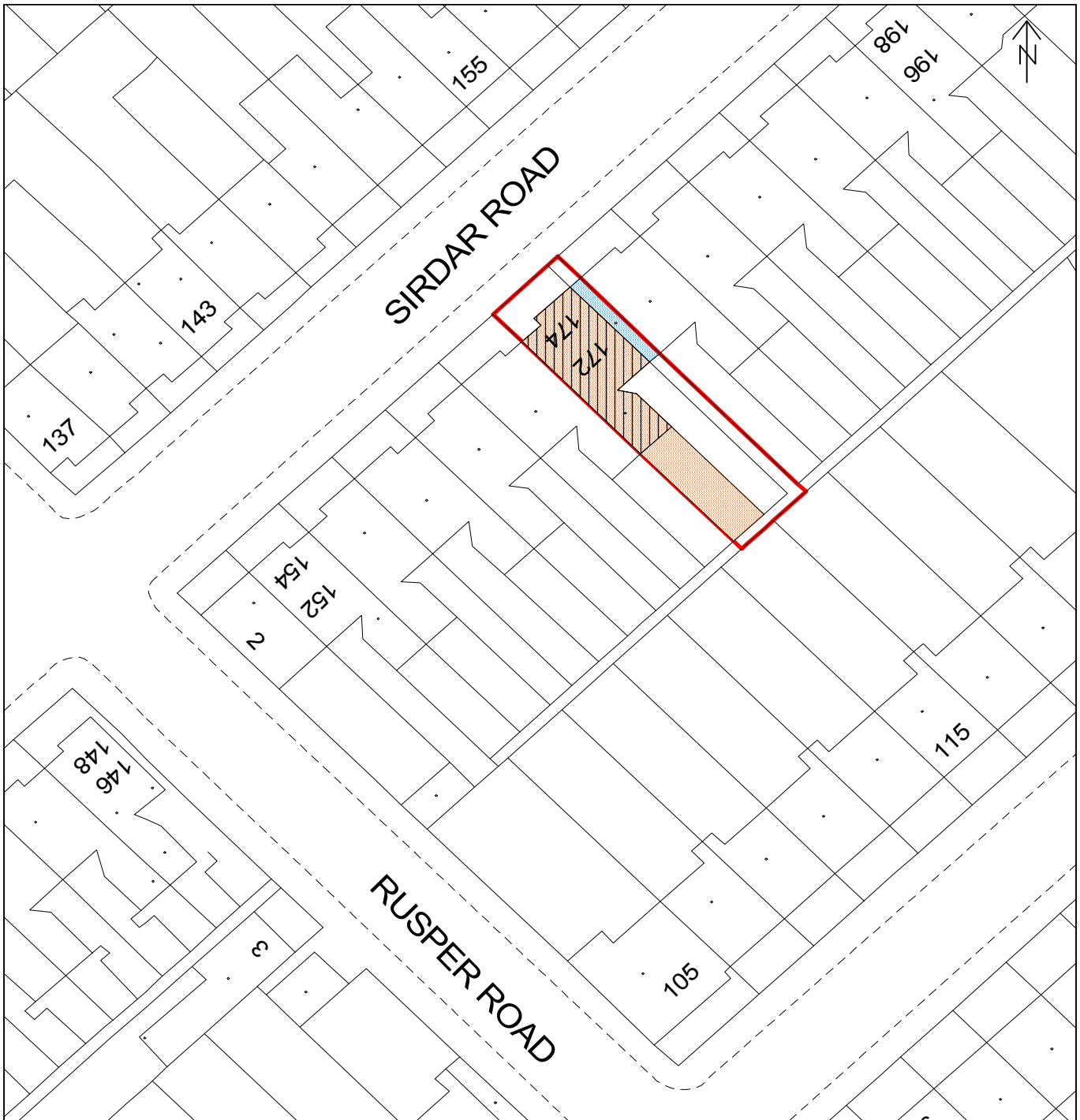

This product includes mapping data licenced from Ordnance Survey with the permission of the Controller of Her Majesty's Stationery Office Crown Copyright 2009 LBH. All rights reserved. Licence no. 100019199

**Haringey Council
CORPORATE PROPERTY SERVICES**

The CPO is of the freehold interest comprised in MX421203 and shown edged red.

The following are excluded from the CPO

1. Tinted blue - rooms over passageway
2. Leasehold interest NGL357375 (172 Sirdar Rd upper maisonette)
 - a. Tinted orange - garden ground
 - b. Tinted orange/hatched black - first floor

Site Area (square metres) : n/a

Overlay : Property Terrier

Plan produced by Janice Dabinett on 01/05/2009

Scale 1:500

Drawing No. BVES A4 2582

**Map referred to in the LONDON BOROUGH OF HARINGEY
(81 Grove Park Road London N15 4SL) COMPULSORY PURCHASE ORDER 2009**



This product includes mapping data licenced from Ordnance Survey with the permission of the Controller of Her Majesty's Stationery Office Crown Copyright 2009 LBH. All rights reserved. Licence no. 100019199

**Haringey Council
CORPORATE PROPERTY SERVICES**

NGL324879 freehold

Site Area (square metres) : 167 sq m

Overlay : *Property Terrier*

Plan produced by Janice Dabinett on 30/04/2009

Scale 1:500

Drawing No. BVES A4 2593

**Map referred to in the LONDON BOROUGH OF HARINGEY
(16 Woodside Road London N22 5HU) COMPULSORY PURCHASE ORDER 2009**

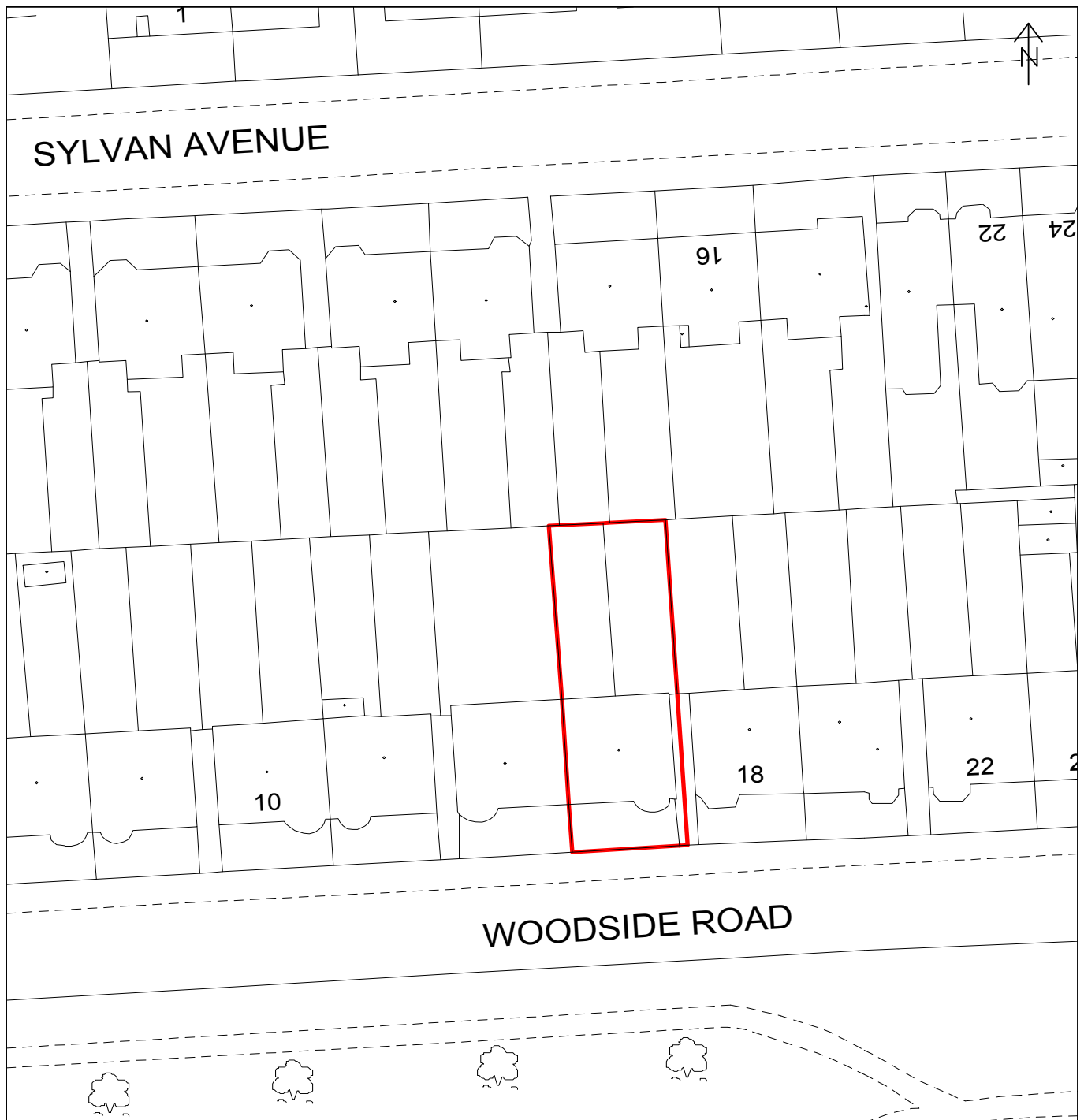

This product includes mapping data licenced from Ordnance Survey with the permission of the Controller of Her Majesty's Stationery Office Crown Copyright 2009 LBH. All rights reserved. Licence no. 100019199

**Haringey Council
CORPORATE PROPERTY SERVICES**

NGL227977 freehold

Site Area (square metres) : 295 sq m

Scale 1:500

Overlay : Property Terrier

Plan produced by Janice Dabinett on 20/03/2009

Drawing No. BVES A4 2583

